

Gibstone Close, Atherton, M46 0GF
£795 PCM

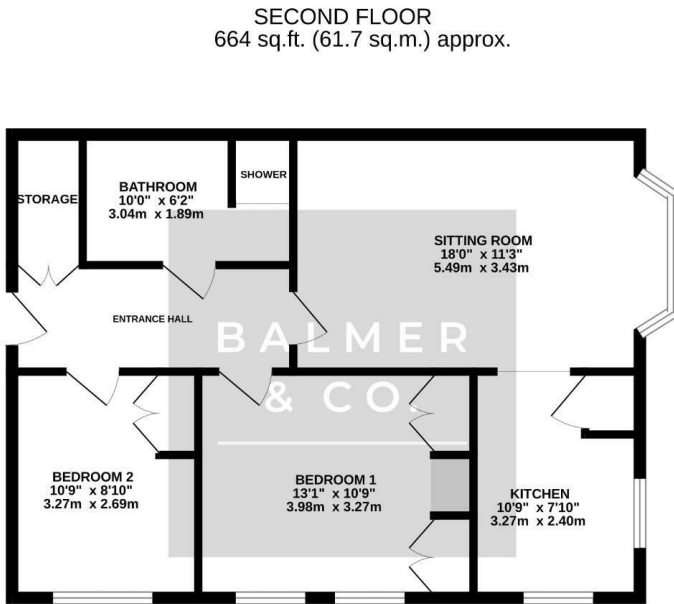

BALMER & CO are delighted to offer TO RENT this two bedroom second floor apartment, available for immediate occupancy. Accommodation comprises in brief, entrance hallway, living room, fitted kitchen, two double bedrooms, master with built in wardrobes, and bathroom. Outside are communal gardens, and car park providing allocated and visitor parking.

Floor Plan



TOTAL FLOOR AREA: 664 sq. ft. (61.7 sq.m.) approx.
Whilst every effort has been made to ensure the accuracy of the foregoing contained herein, measurements of doors, windows, rooms and any other items are approximate and no responsibility is taken for any error, omission or misstatement. The plan is for guidance purposes only and should be used as such by any prospective purchaser. The services, systems and appliances shown have not been tested and no guarantee as to their operability or efficiency can be given.
Made with Metronix ©2024

Area Map

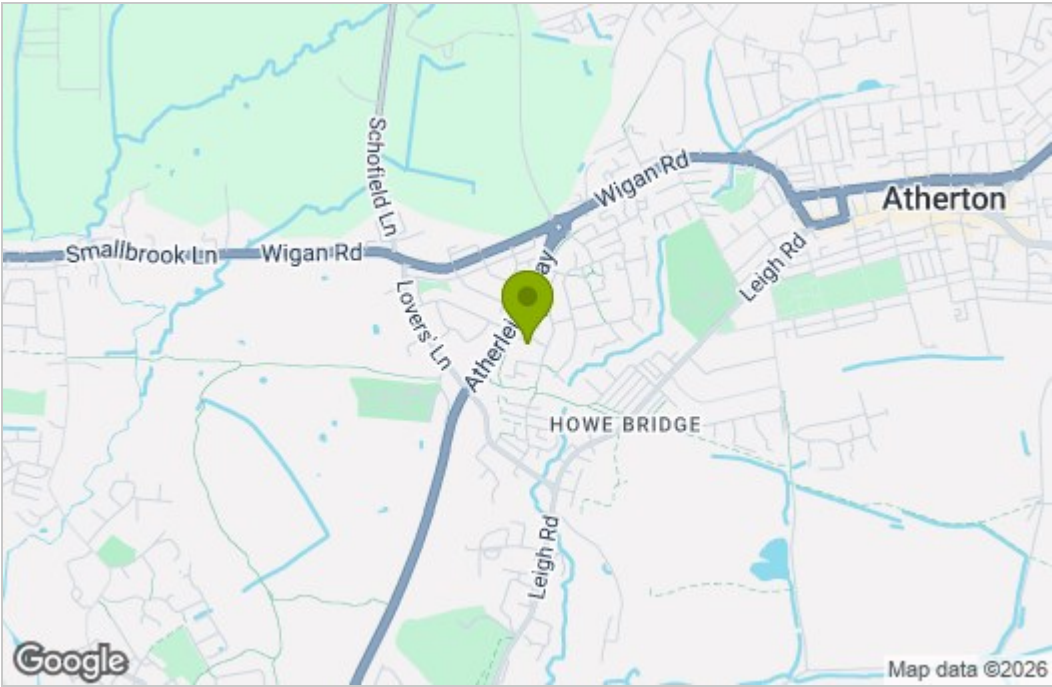

Energy Efficiency Graph

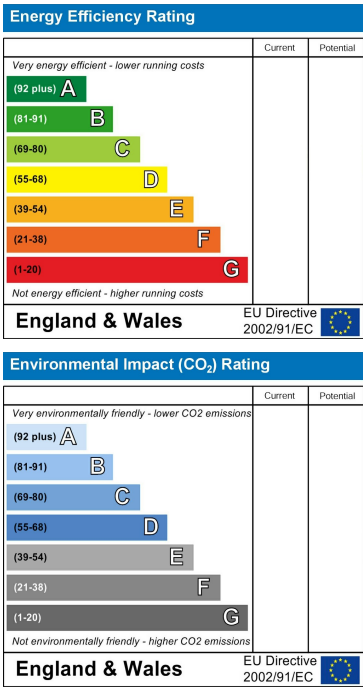

These particulars, whilst believed to be accurate are set out as a general outline only for guidance and do not constitute any part of an offer or contract. Intending purchasers should not rely on them as statements of representation of fact, but must satisfy themselves by inspection or otherwise as to their accuracy. No person in this firm's employment has the authority to make or give any representation or warranty in respect of the property.